

/ Description

Fitting for Pex and Pex-Al-Pex pipe with Gas thread (3/4" Euroconus).



/ Technical data

Working fluids:	water and glycol solutions (max. 50 % of glycol)
Temperature range:	5°C÷110 °C
Minimum working pressure	10 bar

/ Working pipes

PE-X and Pex-Al-Pex cross-linked polyethylene pipes.

/ Products

ART.	CODE	PIPE SIZE	EXT. PIPE SIZE	INT. PIPE SIZE	FITTING THREAD
101	81101GG06	18x2,5	18	13	3/4"
101	81101GK06	20x2,5	20	15	3/4"
101	81101GB06	12x1,1	12	9,8	3/4"
101	81101BM06	12X2	12	8	3/4"
101	81101BN06	14X2	14	10	3/4"
101	81101BW06	16x1,8	16	12,4	3/4"
101	81101GH06	16X2	16	12	3/4"
101	81101GJ06	18X2	18	14	3/4"
101	81101BQ06	20X2	20	16	3/4"
101	81101BO06	16X2,2	16	11,6	3/4"
101	81101BO06	16X2,25	16	11,5	3/4"
101	81101BP06	18X2,2	18	13,6	3/4"
101	81101BR06	20X2,25	20	15,5	3/4"
101	81101GI06	16X1,5	16	13	3/4"
101	81101GN06	20X1,9	20	16,2	3/4"
101	81101GL06	16X2,6	16,2	11	3/4"
101	81101BS06	17x2	17	13	3/4"
101	81101GM06	20x2,9	20	14,2	3/4"

/ Components and materials

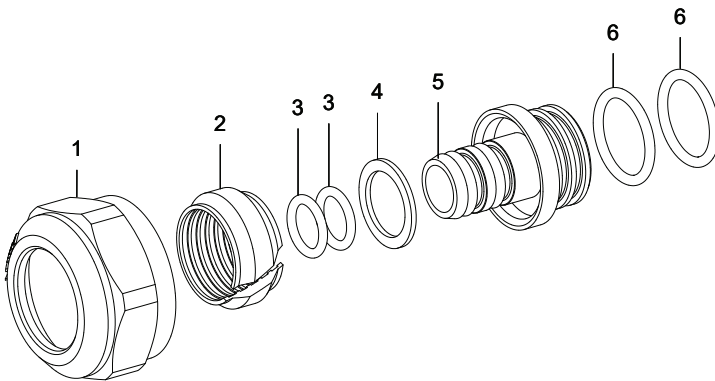

COMPONENT	MATERIAL
1. Loop	Brass
2. Elastic ring	Brass
3. Internal o-Ring	EPDM
4. Separation washer	PVC
5. Adaptor	Brass
6. External o-Ring	EPDM

/ Installation

1. Cut the pipe perpendicularly to its axis
2. Remove any residuals from the cutting
3. Flare the tube
4. Insert the cap on the tube
5. Insert the elastic ring on the tube
6. Lubricate the O-rings and internal surfaces of the tube
7. Insert the fitting into the tube until it stops
8. Connect the wide side of the fitting to the manifold
9. Tighten the loop on the manifold thread with a tightening torque of 40 N

/ Warnings



Applying a tightening torque of less than 40 Nm could compromise the correct functioning of the fitting.