

## / Features

The electromechanical room thermostat remains the simplest and most economical tool for the precise and immediate adjustment of room temperature. Rotating the knob to the desired temperature is all that is needed to adapt the temperature of the room to your own immediate needs.

## / Standards

- CE compliant
- EN 60730
- LDV 2014/35/UE
- EMC 2014/30/UE



## / Warning

Like all heat regulators it must be installed far from the direct influence of heat sources or drafts.

## / Contruction features

- External structure in UV stabilized white thermoplastic material with grey graphics;
- thermostatic block with stainless steel detection membrane, operating through gas expansion;
- silver contacts;
- 230 Vac power supply;
- SPDT contact type;
- contact capacity 10A (1,5A) 250Vac;
- signal light;
- ON/OFF switch;
- working temperature  $5 \div 30\text{ }^{\circ}\text{C}$ ;
- storage temperature  $-20 \div +60\text{ }^{\circ}\text{C}$ ;
- protection class IP20 according to EN60529;
- differential ( $\Delta t$ )  $\leq 1\text{ }^{\circ}\text{C}$ ;
- weight 108 gr.

## / Dimensions

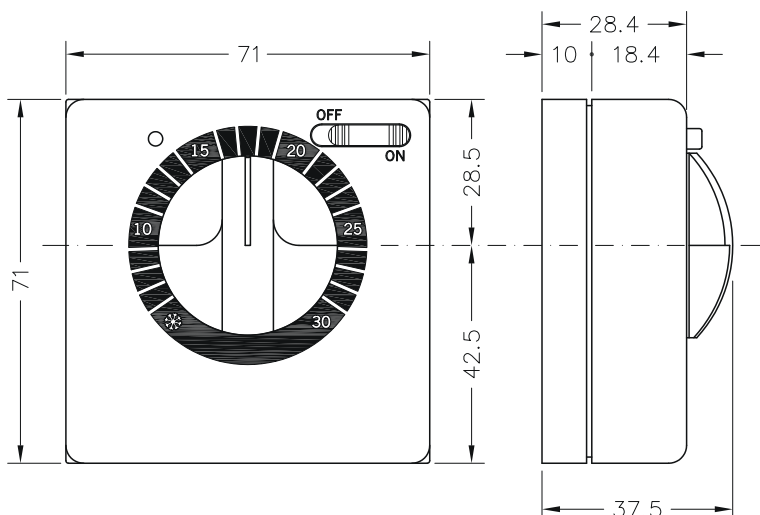

### / Wiring diagram

